

Extras

Vac-Pan installation kit: **£45.00**

(Stainless steel **£25** extra)

- 1 x Plinth mounted Vac-Pan inlet (black, white or cream)
- 500mm Flexi pipe
- 2 x 60mm Jubilee/Terry clips
- 1 x Sharp 90° Trap bend
- 1 x 45° TY branch
- 1 x Straight coupler
- 2 x 90° Swept bends
- 1 x 45° Elbow (female)
- 1 x 45° Elbow (male)
- 1 x Pipe clip
- 5 x Cable ties
- 1.53m of 50mm Ducting
- 3m of Low voltage wire



Extra inlet installation kit: **£42.00**

- 1 x Plastic inlet (white or cream)
- 1 x Inlet mounting brackets
- 1 x Sharp 90° Trap bend
- 1 x 45° TY branch
- 2 x 90° Swept bends
- 2 x 45° Elbows (female)
- 2 x 45° Elbows (male)
- 2 x Straight coupler
- 5 x Pipe clips
- 5 x Cable ties
- 3.06m of 50mm Ducting
- 5m of Low voltage wire



Upgrade to metal inlets **£32.00** each
Inc. Stainless steel, pewter, bronze, nickel,
white, cream or polished chrome.

Installation by SMART

Single unit/static caravan **£180.00**

Twin unit/park home **£210.00**

All prices are inclusive of VAT.



Strathvac Central Vacuums

65 Old Rome Drive

Springhill Meadows

Kilmarnock

Tel: 01563 555881

info@strathvac.co.uk

www.strathvac.co.uk

Size Doesn't Matter...



Eureka Vacuum Kit For Holiday Homes

all the power minimal space

POWER UNIT SPECIFICATIONS

Maximum no. of inlets: 5
 Maximum pipe run: 25m
 Power unit dimensions: 380mm x 185mm Ø
 Airflow: 50 litres/sec
 Air Watts: 500
 (A top of the range Dyson is 280 air watts)
 Waterlift: 2250mm
 Max Input Watts: 1000
 Amps: 6.1
 Filter type: Electrolux S-bag filter with course sponge back-up
 Dirt capacity: 2.5 litre bag
 Motor protection system: yes
 Sound level: 61dbA at 3m
 Cylinder colour: Grey
 Lid colour: Black



STATIC CARAVAN KIT: £395

Powerful Eureka Vacuum Unit

Deluxe Hose & Attachment Set inc:
 5m Crush-proof hose, hose hanger,
 2 x wands, carpet tool, bare floor tool,
 crevice tool, upholstery tool and round
 dusting brush.

2 x Plastic Plug-In Inlets

Installation components inc:

Installation manual & glue
 2 x Inlet mounting brackets
 2 x Sharp 90° Trap bends
 1 x 45° TY branch
 7 x 90° Swept bends
 3 x 45° Elbows (female)
 2 x 45° Elbows (male)
 6 x Straight couplers
 5 x Pipe clips
 20 x Cable ties
 13.77m of 50mm Ducting
 18m of Low voltage wire



PARK HOME KIT: £425

Powerful Eureka Vacuum Unit

Deluxe Hose & Attachment Set inc:

6m Crush-proof hose, hose hanger,
 2 x wands, carpet tool, bare floor tool,
 crevice tool, upholstery tool and round
 dusting brush.
 2 x Plastic Plug-In Inlets

Installation components inc:

Installation manual & glue
 2 x Inlet mounting brackets
 2 x Sharp 90° trap bends
 1 x 45° TY branch
 9 x 90° Swept bends
 5 x 45° Elbows (female)
 4 x 45° Elbows (male)
 8 x Straight couplers
 6 x Pipe clips
 25 x Cable ties
 16.83m of 50mm Ducting
 23m of Low voltage wire

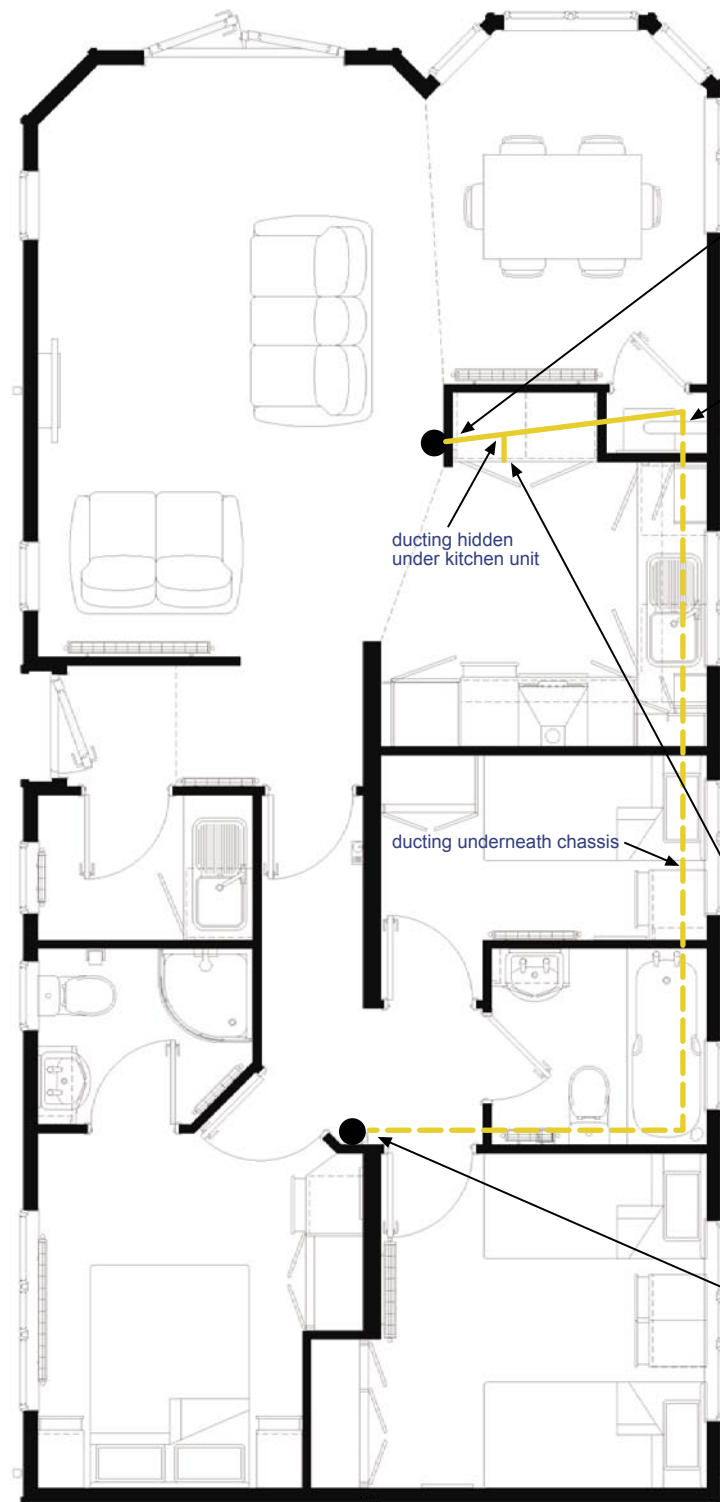

inlet on wall

power unit
 mounted
 underneath
 on chassis
 or in cupboard



ducting hidden
 under kitchen unit

ducting underneath chassis

vac pan inlet
 floor level
 suction point



inlet on floor

